

Periodisk vedligehold

Periodic maintenance

imop 36



Scan QR koden til højre, og se support videoer på i-teamdanmark.dk

Scan the QR code on the right and watch support videos on i-teamdanmark.dk



Følg først alle trin i den daglige vedligehold.

Follow all steps in the daily maintenance.



Rens snavsevanstanken med rent vand og børste.

Clean the dirty water tank with clean water and a brush.



Skru filteret i bunden af snavsevandstanken ud.

Unscrew the filter at the bottom of the dirt tank.



Rens filteret med vand og børste. – evt. afkalk.

Clean the filter with water and a brush – if needed, descale.



Afmontér sugeslangen i bunden af maskinen.

Remove the suction hose at the bottom of the machine.



Frigør sugeslangen fra magneten i toppen.

Release the suction hose from the magnet at the top.

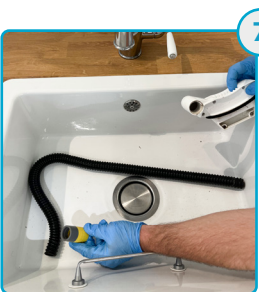

Skru enderne af slangen – drej modsat

Unscrew the ends of the hose – turn counter



Rens endestykkerne med vand – evt. med børste.

Clean the end pieces with water – and optionally a brush.

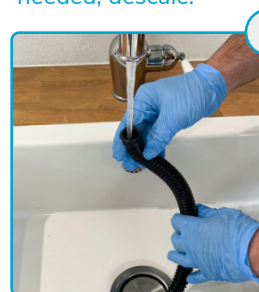

Skyl sugeslangen grundigt med vand.

Rinse the suction hose thoroughly with water.

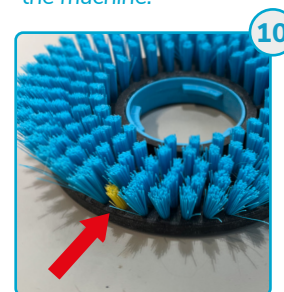

Skift børste, når den er slidt ned til det gule.

Replace brush when it's worn down to yellow.

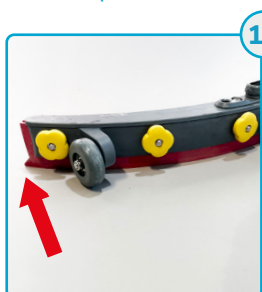

Tjek sugelæber for slid.

Check squeegee for wear.

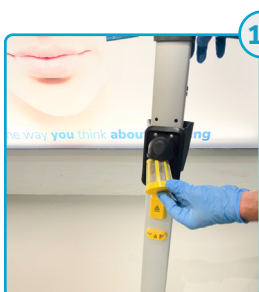

Udtag flydespærren.

Remove the float cage.



Skyl flydespærren i vand.

Rinse the float cage with water.



Saml maskinen og parkér i opret position.

Reassemble the machine and park it upright.